

Gauze Filter as a Pre-filter for electric fuel pumps of the type E1F

New in our program!

Vehicles:	Product:	Fuel gauze filter
Various	Pierburg No.:	4.00030.80.0

Positive displacement pumps are sensitive to contaminants. Contaminants cause wear. The pump mechanism can seize and the pump may be destroyed. Pierburg offers through its new fuel gauze filter a filter which protects the fuel pump reliably against contamination and other foreign particles thereby preventing early failures.

The filter may be easily installed in the fuel line between fuel tank and fuel pumps of the type E1F (having a diameter of 8 mm at the intake port).

The fuel gauze filter should be installed upstream of the following fuel pumps of the type E1F:

- 7.21440.51.0
- 7.21440.53.0
- 7.21440.63.0
- 7.21440.68.0

The fuel pump E1F is supplied with a small protection filter in the intake port. When operated with petrol it may remain in the pump. In the case of diesel operation the filter must be removed since owing to the higher viscosity of diesel at lower temperatures there may be problems.

The replacement intervals for the pre-filter are the same as for the fuel filter.



Product view 4.00030.80.0

Technical data		
Filter surface:	[cm ²]	7.6
Mesh:	[µm]	105
Operating pressure:	[bar]	Up to 2.5

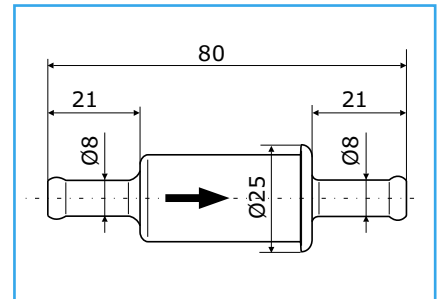

Dimensions

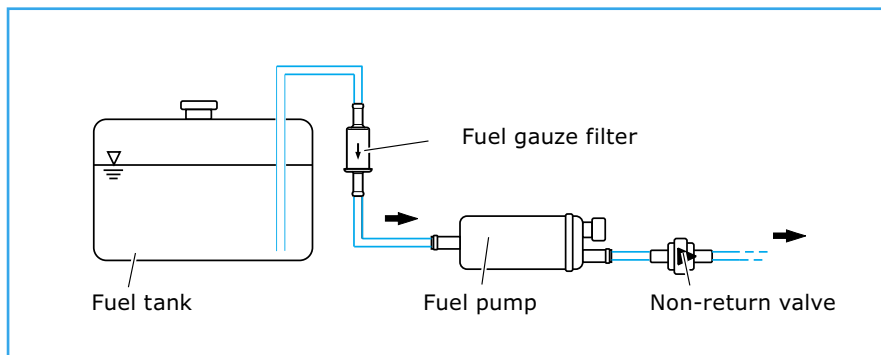

Typical installation situation

Further examples of applications can be found in our brochure: *Service Tips & Information "Fuel Systems Components and solutions for universal applications"*.